

ALISON HARTMAN GARDENS COMMUNITY FEEDBACK FORM

Alison Hartman Gardens Enhancement

- Ways to submit your comments:
- put in comments box in Library
 - mail to: PO Box 484, Albany, 6330
 - email to: staff@albany.wa.gov.au

Please mark email or postal submissions for the attention of Major Projects,
Albany City Hub Submissions close 14 November 2017

NAME:

ADDRESS:

(optional)

.....

.....

PHONE & EMAIL: AGE:

FEEDBACK:
PLEASE TURN OVER FOR AREA MAP:

.....
.....
.....
.....
.....
.....
.....
.....
.....
.....
.....
.....
.....
.....
.....
.....
.....
.....
.....
.....
.....
.....

DATE: SIGNATURE:



LEGEND

- 1. Mokare Statue
- 2. Central Pathway
- 3. Norfolk Island Pine Tree
- 4. Oak Tree
- 5. Open Lawn Areas + Gardens
- 6. Retaining Walls + Steps
- 7. Albany State School Heritage Site
- 8. Former Headmaster's House
- 9. Library
- Cadastral Boundary
- Alison Hartman Gardens Reserve Boundary

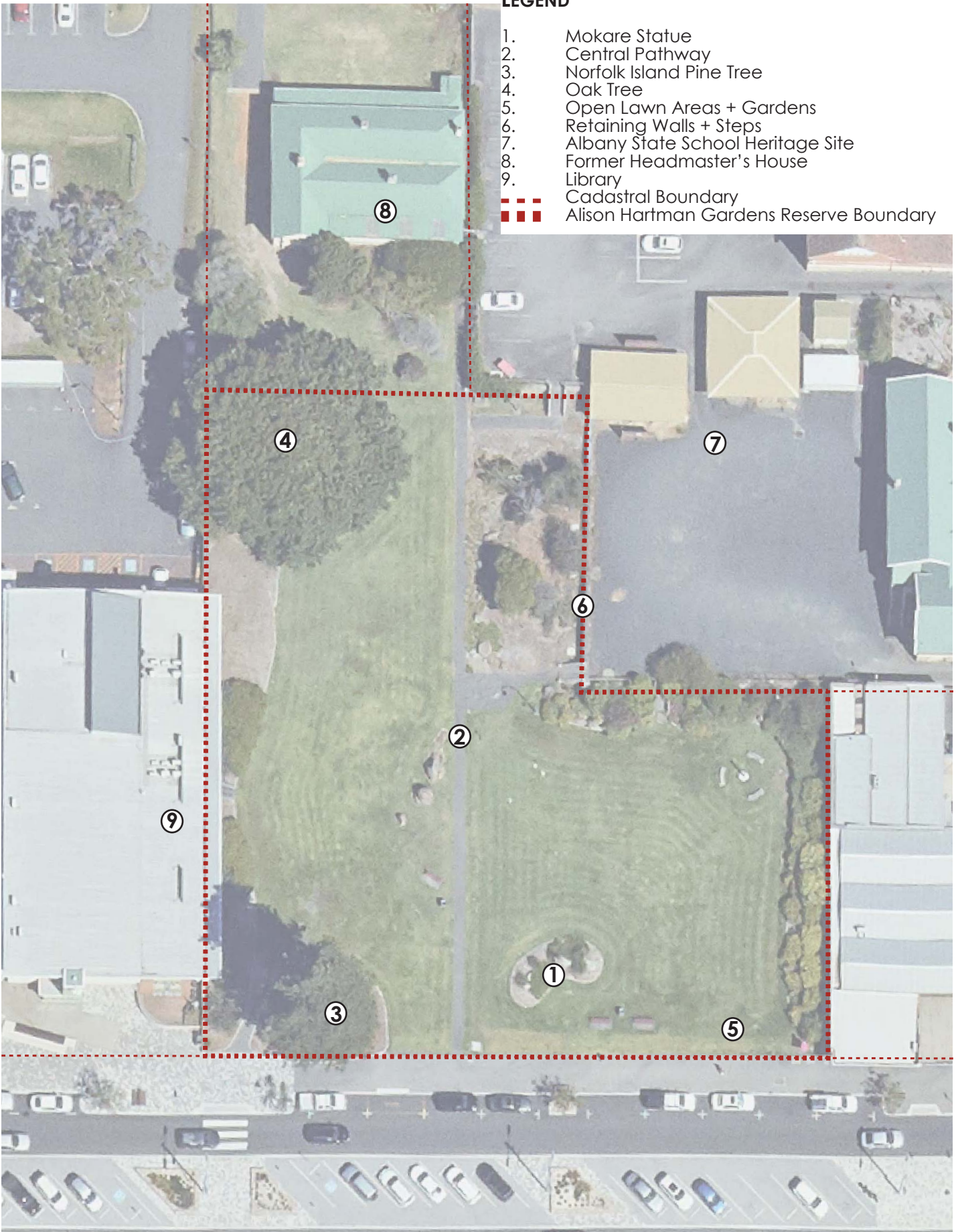

York Street

YOUR DRAWINGS ARE WELCOME HERE

